

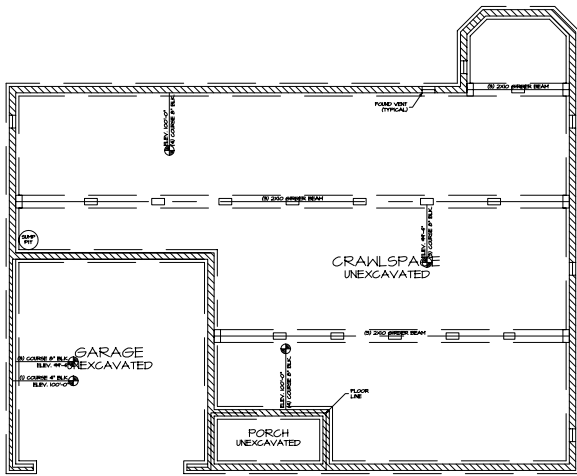

FRONT ELEVATION
A-1 SCALE: 1/4"=1'-0"



FOUNDATION PLAN
A-2 SCALE: 1/4"=1'-0"

- FOUNDATION PLAN NOTES:**
1. ALL DIMENSIONS ARE TO FINISH WALL FACE, UNLESS NOTED OTHERWISE.
 2. ALL FOUNDATION WALLS TO BE 8" MIN. THICK CONCRETE.
 3. ALL FOUNDATION WALLS TO BE 4" MIN. THICK CONCRETE.
 4. ALL FOUNDATION WALLS TO BE 4" MIN. THICK CONCRETE.
 5. ALL FOUNDATION WALLS TO BE 4" MIN. THICK CONCRETE.
 6. ALL FOUNDATION WALLS TO BE 4" MIN. THICK CONCRETE.
 7. ALL FOUNDATION WALLS TO BE 4" MIN. THICK CONCRETE.
 8. ALL FOUNDATION WALLS TO BE 4" MIN. THICK CONCRETE.
 9. ALL FOUNDATION WALLS TO BE 4" MIN. THICK CONCRETE.
 10. ALL FOUNDATION WALLS TO BE 4" MIN. THICK CONCRETE.

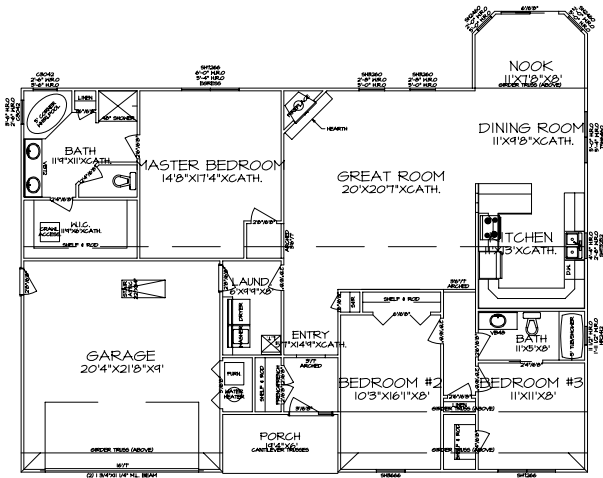

FIRST FLOOR PLAN
A-3 SCALE: 1/4"=1'-0"

- FLOOR PLAN NOTES:**
1. ALL DIMENSIONS ARE TO FACE OF WALL, UNLESS NOTED OTHERWISE.
 2. ALL INTERIOR WALLS TO BE 5/8" THICK GYP BOARD.
 3. ALL INTERIOR WALLS TO BE 5/8" THICK GYP BOARD.
 4. ALL INTERIOR WALLS TO BE 5/8" THICK GYP BOARD.
 5. ALL INTERIOR WALLS TO BE 5/8" THICK GYP BOARD.
 6. ALL INTERIOR WALLS TO BE 5/8" THICK GYP BOARD.
 7. ALL INTERIOR WALLS TO BE 5/8" THICK GYP BOARD.
 8. ALL INTERIOR WALLS TO BE 5/8" THICK GYP BOARD.
 9. ALL INTERIOR WALLS TO BE 5/8" THICK GYP BOARD.
 10. ALL INTERIOR WALLS TO BE 5/8" THICK GYP BOARD.

STATISTICS:	
AREA:	EXISTING: PROPOSED:
FIRST FLOOR AREA:	N/A 1,921 S.F.
SECOND FLOOR AREA:	N/A N/A
TOTAL LIVING AREA:	N/A 1,921 S.F.
BASEMENT AREA:	N/A N/A
GARAGE AREA:	N/A 457 S.F.
TOTAL AREA:	N/A 2,378 S.F.

GALLIVAN'S
DRAFTING & DESIGN
(217) 202-5998